

ROUNDUP PUMP 'N GO FAST ACTION WEEDKILLER - 5L

KILLS THE ROOTS - SO WEEDS DON'T COME BACK - TREATS UP TO 150M²

- **Fast Acting on all weeds**
- **Perfect for paths, Drives, Patios and Flower Beds**
- **Degrades in soil to allow replanting**

FAST ACTION ROUNDUP Ready-to-Use Weedkiller

Multi-purpose weedkiller, kills annual and deep rooted perennial weeds, including grasses, dandelions, docks, nettles, ground elder, bindweed and thistles. It is inactivated on contact with the soil and is then broken down by soil micro-organisms, to allow replanting.

KEEP CHILDREN AND PETS OUT OF TREATED AREAS UNTIL DRY.

New! Pump 'N Go Sprayer System Instructions for Use

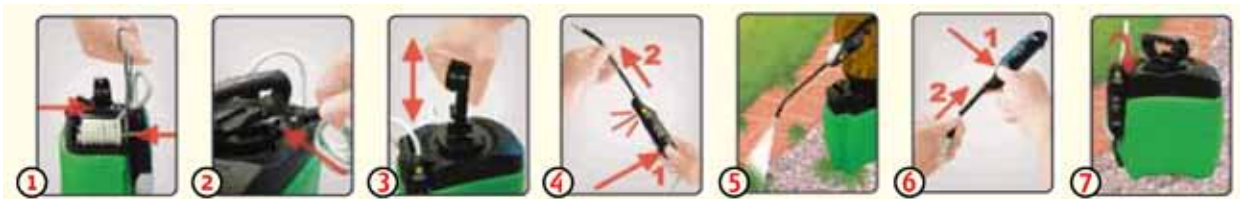

Although not a requirement, as good practice, we recommend wearing waterproof gloves and gardening footwear.

- 1. CUT** - Cut the white ties to release the hose and wand.
- 2. CONNECT** - Connect the hose to the pack as shown. This is a quick couple system which is not reversible i.e. once in place cannot be removed without force.
- 3. PUMP** - Pump handle up to 20 times for 3 minutes of spray. After pumping, push handle down, turn clockwise to lock into carry position.
- 4. EXTEND WAND** - Lift sprayer off bottle, push yellow button while pulling lance until it snaps into spray position.
- 5. SPRAY** - Adjust spray pattern by turning the nozzle. Aim 50 cm from target weed and press white trigger. Spray to lightly wet the leaves avoiding run-off.
- 6. RETRACT WAND** - After use, push the yellow button and retract the wand to its original position before clipping it onto the side of the pack for storage. This will prevent the accidental release of spray solution when in the storage position.
- 7. STORE** - Push pump handle down, turn pump handle and cap anti-clockwise to relieve pressure, then retighten before storage.

When to use

- Spray at any time when the weeds are actively growing and have adequate leaf area to absorb the spray.
- Rain within 6 hours of spraying reduces effectiveness and repeat treatment may be necessary.
- Apply in calm conditions to avoid drift onto cultivated plants.

Where to use

Controls most weeds around the garden, e.g. gravel areas, paths, drives, hard surfaces, patios, tarmac, along fences and for edging lawns. It can be used to clean up weedy ground before planting vegetables, flowers, bushes and trees, and to renovate overgrown areas. **DO NOT USE ON LAWNS OR OTHER WANTED PLANTS** unless you want to kill them.

- Treat established perennial weeds at the start of flowering to give best results.
- Spray nettles and ground elder when new leaves have unfolded fully in late spring.
- Weeds may show first effects from a few days up to 4 weeks, depending on the weather and the type of weed.
- Leave weeds 7 days before digging or soil cultivation, for the weedkiller to move to the roots.
- Repeat application if necessary, should new growth appear.

RESTRICTIONS Avoid contact by spray and spray drift with cultivated plants and desired vegetation

- To avoid transfer to lawns and other desired vegetation do not walk into treated areas until the product has dried

This product is a home garden weedkiller for use on unwanted vegetation and areas not intended to bear vegetation. It contains 7.2g/l glyphosate acid (present as 9.7g/l) IPA salt of glyphosate in a ready to use solution

SAFETY INFORMATION

KEEP PRODUCT AWAY FROM CHILDREN AND PETS. KEEP AWAY FROM FOOD AND DRINK.

If swallowed, seek medical advice immediately and show this container or label.

Do not contaminate water with product or its container.

This material and its container must be disposed of in a safe way.

Do not empty into drains.

TO AVOID RISKS TO MAN AND THE ENVIRONMENT, COMPLY WITH THE INSTRUCTIONS FOR USE

MAPP 14481 PCS N° 03726

SAFETY INSTRUCTIONS UK Only :

Protection during/in use : KEEP OFF SKIN. WASH OFF SPLASHES IMMEDIATELY. WASH HANDS AND EXPOSED SKIN AFTER USE.

Storage and disposal : KEEP PRODUCT IN ORIGINAL CONTAINER, tightly closed, in a safe place. Dispose of empty container in the dustbin. Dispose of unused product in its container at a household waste site (civic amenity site).

Contact your local council (local authority) for details.



Keep children and pets away from treated areas until spray has dried



CHILD SAFE TRIGGER

Roundup® is a registered trade mark of Monsanto Technology LLC. © Monsanto

Approval Holder: Monsanto UK Ltd POBox663 Cambourne, Cambridge, CB1 0LD

Monsanto Roundup, Lawn & Garden, Salisbury House, Weyside Park, Catteshall Lane, Godalming, Surrey, GU7 1XE

Telephone: From UK 0870 530 1010 From ROI 00 44 870 530 1010

www.roundup-garden.com